



Jewish Federation of Fort Wayne
 5200 Old Mill Road
 Fort Wayne, IN 46807
 260-456-0400

CAMP JOE LEVINE APPLICATION

Camper's Name _____ Male _____ Female _____ Birth Date _____ Age _____
 Address _____
 City _____ Zip _____ Home Phone _____
 Parents' Contact Information:
 Name _____ Work Phone _____ Cell _____
 Name _____ Work Phone _____ Cell _____
 Email(s): _____

Camp Joe T-Shirt included! Mark the size below.

CHILD: XS _____ S _____ M _____ L _____ ADULT: S _____ M _____ L _____ XL _____

Week 1: July 9-13	_____	9AM-4PM	\$140/Week	_____
AM Care:	9 _____ 10 _____ 11 _____ 12 _____ 13 _____		(\$4/Day)	_____
PM Care:	9 _____ 10 _____ 11 _____ 12 _____	**	(\$4/Day)	_____
** NO PM Care on Fridays				

Week 2: July 16-20	_____	9AM-4PM	\$140/Week	_____
AM Care:	16 _____ 17 _____ 18 _____ 19 _____ 20 _____		(\$4/Day)	_____
PM Care:	16 _____ 17 _____ 18 _____ 19 _____	**	(\$4/Day)	_____
** NO PM Care on Fridays				

Week 3: July 23-27	_____	9AM-4PM	\$140/Week	_____
AM Care:	23 _____ 24 _____ 25 _____ 26 _____ 27 _____		(\$4/Day)	_____
PM Care:	23 _____ 24 _____ 25 _____ 26 _____	**	(\$4/Day)	_____
** NO PM Care on Fridays				

Sub Total: _____
 Optional 5 x 7 Camp Picture: \$3.00 _____
 Sibling Discount: - \$20.00 _____
 Deposit: - \$50.00 _____
Register by April 1st to receive an early registration discount.
Early Registration Discount: - 10% _____
 Total Fees for Camper: _____

Balance to be paid in full by June 17, 2018. Thank you.

PLEASE NOTE: We want all children to have an opportunity to attend camp. Limited assistance is available for campers. I am interested in assistance for my child/ren. _____ Yes/ _____ No

ELECTIVE SCHEDULE - SUMMER 2018

Our elective program is designed to accommodate our campers' particular interests and talents. When helping your child select an elective, please be advised of the following:

- a) Please, indicate your camper's first, second, and third choices by marking 1, 2, and 3 in the "Camper's Choice" section for **each week**. We will attempt to assign all children to the electives of their preference.

Sample

<i>Week</i>	<i>Elective</i>	<i>Age</i>	<i>Description</i>	<i>Camper's Choice</i>
July 3-7	<i>Jewish Arts</i>	4-7	<i>The projects include artwork commemorating Israel at 60 and other Jewish crafts.</i>	1
	<i>Sports and Games</i>	4-7	<i>The children will play some of their favorite sports and outdoor games.</i>	3
	<i>Hebrew with Games</i>	4-7	<i>Have fun learning Hebrew basics while singing, and playing games</i>	2
	<i>Jewish Arts</i>	8-13	<i>The projects include artwork commemorating Israel at 60 and other Jewish crafts.</i>	
	<i>Strategy & Logic Games</i>	8-13	<i>Enjoy the challenge of playing games requiring logic and strategy.</i>	
	<i>Let's Learn about Israel</i>	8-13	<i>Join our Israeli counselors as you learn facts about Israel's history.</i>	

- b) Your child may sign up for a different elective each week or for the same elective for two or three weeks.
- c) Please follow the age guidelines.
- d) There is a minimum of four campers and a maximum of eight campers for each elective. The campers will be assigned to electives based on the order in which applications are received.
- e) Please send your completed elective form with the camp application.

Camper's NAME _____

Camper's Age: _____

Week	Elective	Age	Description	Camper's Choice
July 9-13	Jewelry Making	4-7	Make your own necklaces, bracelets, and headbands.	
	Lego Mania		Children will use their creativity and imagination to construct various items.	
	Outdoor Fun		Enjoy the fresh air while playing Follow the Leader, making sidewalk art and more.	
	Kosher Treats	8-13	Prepare simple nutritious snacks.	
	Board Games		Q-Bitz, Chess, Checkers, Spot It, Distraction, and other fun games.	
	Sports & Games		Children will play some of their favorite sports and outdoor games.	
July 16-20	Jewish Arts	4-7	Projects include a variety of Jewish crafts.	
	Lego Mania!		Children will use their creativity and imagination to construct various items.	
	Outdoor Fun		Enjoy the fresh air while playing Follow the Leader, making sidewalk art and more.	
	Young Designer	8-13	Take everyday items and old clothes to make something new and trendy.	
	Origami		Learn how to make simple origami items.	
	Hiking Fox Island		Exercise and experience the beauty of nature at Fox Island.	
July 23-27	Board Games	4-7	Jigsaw puzzles, Hoot Owl Hoot! Clue and other fun games.	
	Lego Mania		Children will use their creativity and imagination to construct various items.	
	Outdoor Fun		Enjoy the fresh air while playing Follow the Leader, making sidewalk art and more.	
	Kosher Treats	8-13	Prepare fun and delicious desserts.	
	Sports & Games		The children will play some of their favorite sports and outdoor games.	
	Drawing		Relax and enjoy coloring some of the "grownup" geometric designs in a company of friends.	

INSTRUCTIONS – Please complete a separate form for each camper. Thank you.

CAMPER INFORMATION			
Camper Name	Home Phone	Date of Birth	Age at Camp
Address	City	State	Zip
PARENT INFORMATION			
Name of Mother		Work/Day Phone	Cell Phone
Name of Father		Work/Day Phone	Cell Phone
EMERGENCY CONTACT (Someone other than parents)			
Name		Work/Day Phone	Cell Phone
INSURANCE INFORMATION			
Insured	Name of Company	Policy information	
HEALTH HISTORY (check all that apply)			
Allergies <input type="checkbox"/> Animals _____ <input type="checkbox"/> Food _____ <input type="checkbox"/> Hay Fever _____ <input type="checkbox"/> Insect Stings _____ <input type="checkbox"/> Medicine/Drugs _____ <input type="checkbox"/> Plants _____ <input type="checkbox"/> Pollen _____ <input type="checkbox"/> Other (specify) _____ _____		Chronic or Recurring Illness <input type="checkbox"/> Ear Infections <input type="checkbox"/> Heart Disease <input type="checkbox"/> Seizures <input type="checkbox"/> Bleeding Disorder <input type="checkbox"/> Asthma <input type="checkbox"/> Hypertension <input type="checkbox"/> Diabetes <input type="checkbox"/> Musculoskeletal Disorder <input type="checkbox"/> Other (specify) _____ _____	
Suggestion from Parents: My child has permission to take or use the following: <input type="checkbox"/> Tylenol/acetaminophen <input type="checkbox"/> Advil/Ibuprofen <input type="checkbox"/> Benadryl/antihistamine <input type="checkbox"/> Neosporin/Triple Antibiotic cream <input type="checkbox"/> Other _____ _____			
ADDITIONAL INFORMATION			
Name of Doctor		Phone Number	
CURRENT MEDICATIONS			
Name	Dosage	Time of Day	
Name	Dosage	Time of Day	
Name	Dosage	Time of Day	
DIETARY INFORMATION (does not eat or is allergic to)			
<input type="checkbox"/> Milk	<input type="checkbox"/> Peanuts	<input type="checkbox"/> Eggs	
<input type="checkbox"/> Other Dairy	<input type="checkbox"/> Wheat	<input type="checkbox"/> Other (specify):	
ACTIVITY RESTRICTIONS			
Explain any restrictions, e.g., what cannot be done, what adaptations or limitations are necessary.			

Parent/Guardian Signature

Date

Camp Joe Levine Pickup/Drop-off Authorization Slip

Camper's name: _____

In addition to a camper's parents/legal guardians, I authorize these people to drop-off or pick up my child.

1. _____

2. _____

The staff of Camp Joe Levine **WILL NOT** authorize any other pickup arrangements without a signed note from a camper's parent/guardian. Thank you.

Parent Signature

Date

BRING A FRIEND DAY - MONDAY, JULY 16!

Each camper may bring one friend, free of charge, to enjoy a wonderful day at Camp Joe, including:

- Fun filled Judaica and Hebrew
- Sand castle building contest
- Swimming
- Games
- And more...

Please complete and return this form no later than Wednesday, July 7.

Camper's name: _____

Friend's name: _____

Friend's age: _____

Getting to Fox Island:

- **From SW Allen County:** Jefferson Road/U.S. 24 turn onto Yohne Road (the road adjacent to the Kroger Store). Fox Island is ~ 1 mile on the left hand side of the road. Enter the park. Drive a short distance to the stop sign. Go straight. This will take you to the Bird Observation Building where you will drop off your child/ren.
- **From NW Allen County:** I-69 to exit 102. Turn right on Jefferson Blvd. /U.S. 24. At the second light, turn left onto Yohne Road. Fox Island is ~ 1 mile on the left hand side of the road. Enter the park. Drive a short distance to the stop sign. Go straight. This will take you to the Bird Observation Building where you will drop off your child/ren.
- **From NE Allen County or within city limits:** You will want to take a main road to Jefferson Blvd. Clinton or Ardmore Extended/Hilligas to Jefferson is best. Turn west on Jefferson. At the west edge of town, Jefferson and I-69 intersect. Continue west two more lights. Turn left on Yohne Road by Kroger's. Fox Island is ~ 1 mile on the left hand side of the road. Enter the park. Drive a short distance to the stop sign. Go straight. This will take you to the Bird Observation Building where you will drop off your child/ren. (Ardmore is closed between Jefferson and Taylor.)

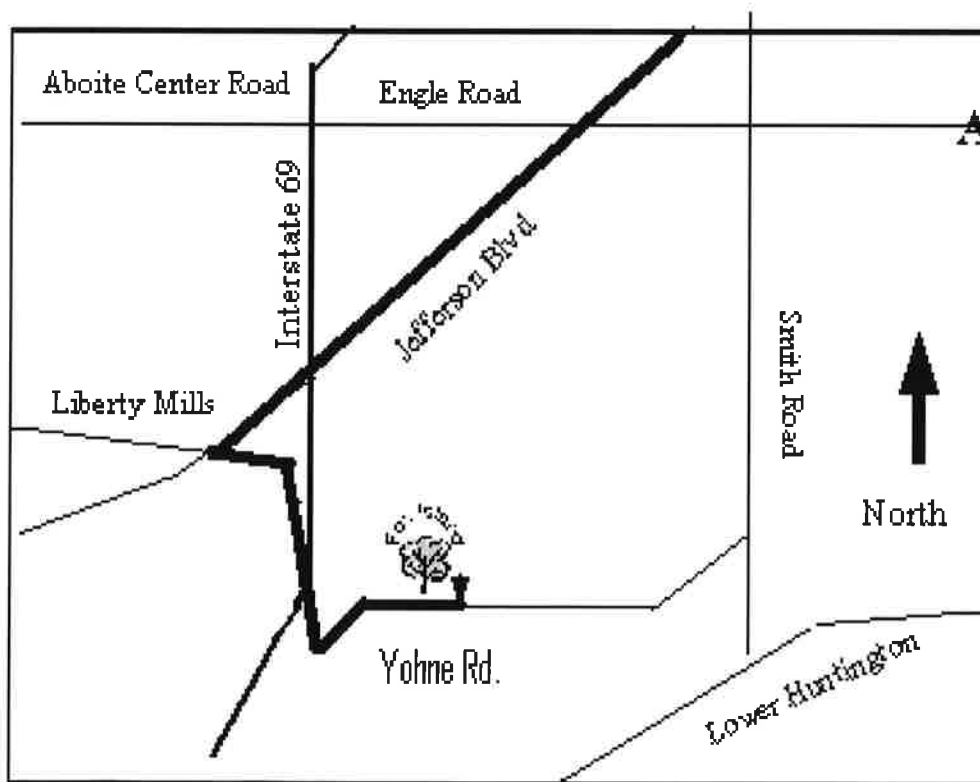

Allen County Parks
in Southwestern
Allen County

Jewish Federation of Fort Wayne



REQUIRED READING FOR PARENT AND CHILD:
Please keep this Code of Honor. Sign and return the Camper Permission & Agreement Form included in your packet.

Code of Honor

The Jewish Federation of Fort Wayne Code of Honor is based on four key areas: **Respect, Honesty, Cooperation and Safety.** Campers, parents and staff are expected to adhere to these important principles which we believe are the key elements to maintaining a positive, meaningful community at camp.

Only by working together, can we keep our community vital and productive. We must respect the goals and responsibilities of the community and its leaders. We must work to create a community where children feel safe, supported and encouraged, even when taking risks or accepting new challenges. We must be honest in our interactions. And we must join efforts to give every camper the opportunity to flourish.

camper

respect

I understand that others are different, and I will treat them with kindness no matter how they look, what they can do, what they believe or where they are from.

I will show respect for others by solving problems in a way that is not verbally or physically harmful or dangerous to me or others.

I am responsible for my camp community and will treat the grounds, buildings and possessions with respect by not damaging, stealing or breaking things.

honesty

I will be a trustworthy person.
I will accept and follow the camp rules.
I will tell the truth.

cooperation

I will be a valuable member of the camp community by accepting responsibility for myself: what I do, what I say and the choices I make.

safety

I will keep my hands to myself. I will not hurt others. I will follow the rules wherever I am because rules help to make my camp a safe, fun place to be.

parent

respect

I/We will respect and comply with camp policy, and understand that policies are set forth for the greater good of the camp community.

I/We will respect individual differences among campers, parents and staff.

I/We will treat staff, campers and other parents with thoughtfulness and consideration and refrain from using negative or abusive language.

honesty

I/We will be honest, truthful and fair in all interactions with staff, campers and other parents.
I/We will inform camp administration of all medical, emotional, and psychological factors that may influence the behavior of our camper.
I/We will respect those decisions made by camp staff.

cooperation

I/We will work in cooperation with staff to achieve common goals for campers, families and the camp community.
I/We will actively support the camp to implement camp rules and policies.

safety

I/We are committed to helping staff protect the community from risk of harm or injury.
I/We understand that there will be consequences for our and our child's negative behaviors that threaten the emotional well-being of the camp community.

Behavior & Consequences

Camper

I understand that following the Jewish Federation of Fort Wayne Code of Honor helps everyone enjoy camp and that there will be consequences when I choose not to follow it.

Parent

At camp, we strive to teach children how to be good "community members." Occasionally, however, campers will act inappropriately, sometimes engaging in unsafe or aggressive behaviors. The following behaviors will result in the consequences enforced.

Behavior	1st Occurrence	2nd Occurrence	3rd Occurrence
Abusive language, disrespect to others, willful disobedience, fighting, biting, physical aggression, kicking, hitting, spitting	Conference with camper and a phone call home to parents.	Conference with camper and a phone call home to parents. Parents will be responsible to pick up camper immediately. A one-day suspension from camp will occur.	Immediate expulsion from camp without refund.
Stealing, destruction of property, vandalism	Conference with camper and a phone call home to parents. Parents responsible for property damage.	Conference with camper and a phone call home to parents. Parents responsible for property damage. A one-week suspension from camp will occur.	Immediate expulsion from camp without refund.
Smoking, drugs, alcohol, weapons	Immediate expulsion from camp without refund.		



Camper: _____ Date: _____

Parent: _____ Date: _____